

# Central Investment Proposition - Adding Fund Lists

Last Modified on 13/02/2024 3:35 pm GMT

This article is a continuation of [Central Investment Proposition - Adding Portfolios](#)

Add fund lists in the **Fund Lists** tab:

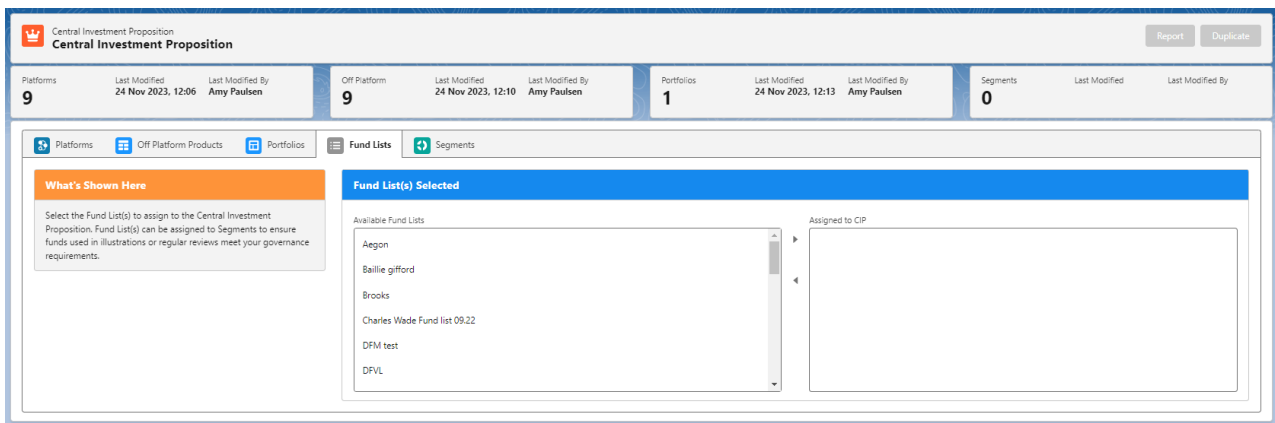
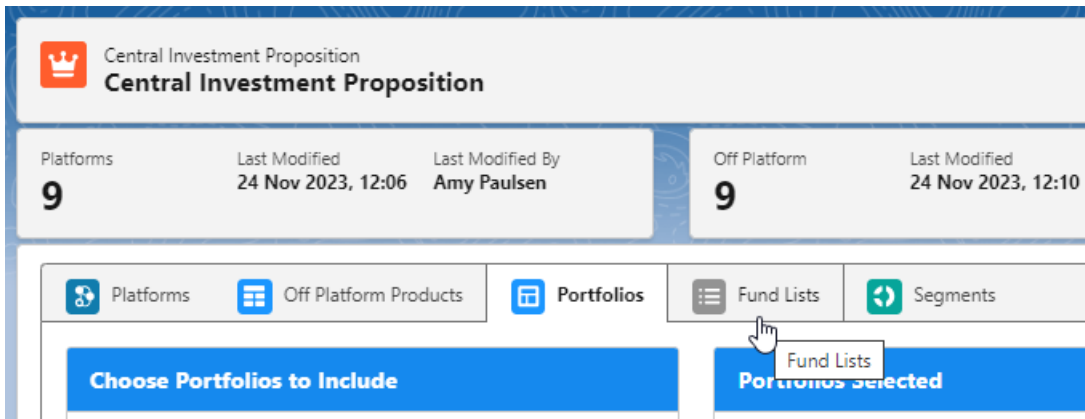

Select the fund list/s you would like to add to the CIP:

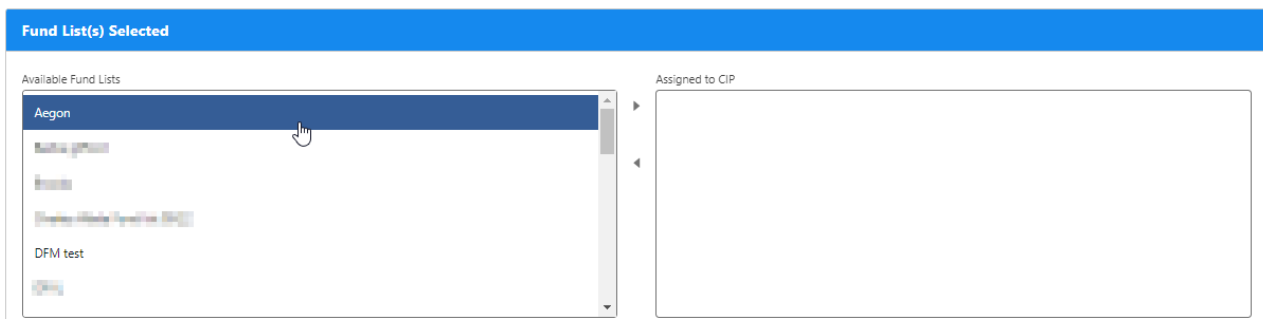

Use the arrow to move the list to **Assigned to CIP**

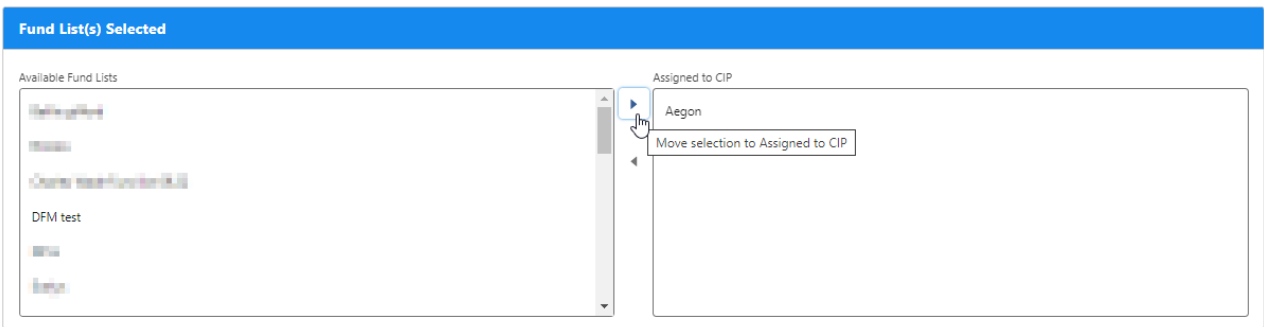
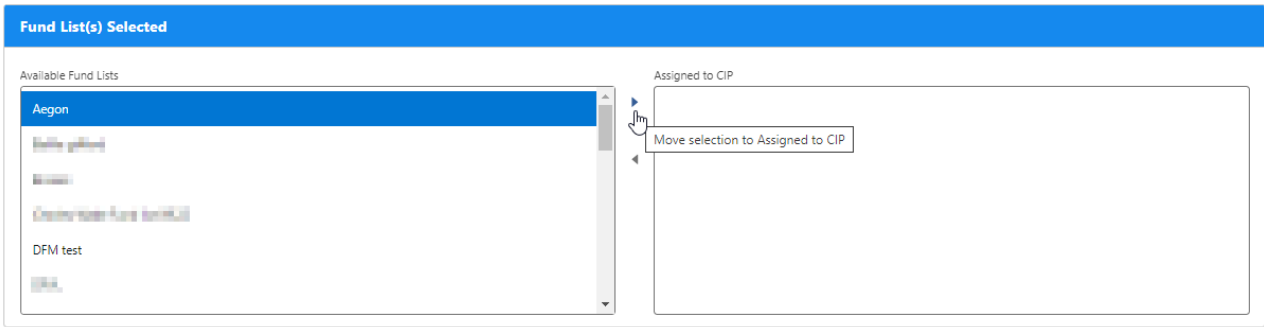

For more information on configuring your CIP, see article [Central Investment Proposition - Creating Segments](#)